

Tous droits strictement reserves. Reproduction ou communication a des tiers interdite sous quelque forme que ce soit sans autorisation ecrite du propriétaire. Propriete de c FCI. Droits de reproduction FCI.



All rights strictly reserved. Reproduction or issue to third parties in any form whatever is not permitted without written authority from the proprietor. Property of FCI. Copyright FCI.

PRODUCT NUMBER
51968-A00CCC00EF_..
SEE NOTE 1

1 | 2 | | | | | | | | | | 3 | 4

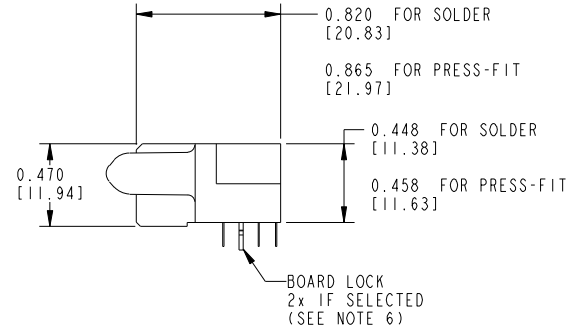
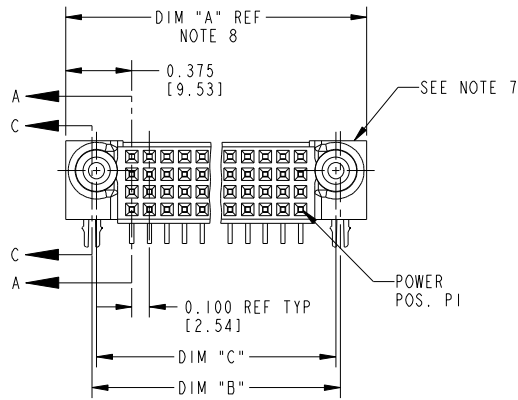
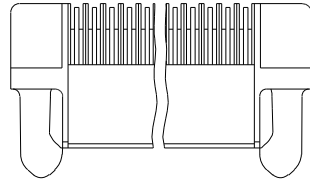

THIS FILE WAS ORIGINALLY CREATED IN THE PRO ENGINEER ENVIRONMENT AND ANY FUTURE REVISIONS TO THIS FILE MUST BE MADE IN THE PRO ENGINEER ENVIRONMENT

mat'l code SEE NOTE 2				tolerances unless otherwise specified		CUSTOMER COPY	www.fciconnect.com	
ltr	ecn no.	dr	date	linear	.XX±.01/.X±.3		title RIGHT ANGLE RECEPTACLE w/GUIDE PIN SIGNAL	
A	V04-0660	TAB	06/23/04		.XXX±.005/.XX±.13		product family PwrBlade code 213 size dwg no 51968 SHEET 1 OF 3	
B	DG07-0080	RYAN	03/09/07		.XXX±.0020/.XXX±.051			
C	DG08-0239	JC	09/12/08	angles	0°±2°	INCH / MM	scale 1:1	
				dr	T. BRUNGARD 06/23/04	A		cage code 22526
				enr	M. GRAY 06/23/04			
				chr	M. GRAY 06/23/04			
				appd	M. GRAY 06/23/04			
sheet index	revision sheet	C	C	C				
		1	2	3				

form no. 7530-001-103

1 | 2

3 |

4

Tous droits strictement réservés. Reproduction ou communication à des tiers interdite, sous quelque forme que ce soit sans autorisation écrite du propriétaire. Propriété de c.FCI. Droits de reproduction FCI.



All rights strictly reserved. Reproduction or issue to third parties in any form whatever is not permitted without written authority from the proprietor. Property of FCI. Copyright FCI.

PRODUCT NUMBER
51968-A00CCC00EF_
SEE NOTE 1

CONNECTOR NOTES

- ①. PRODUCT NUMBER CODE:
51968 - A 00 CCC 00 E F LF
 - W/O THIS SUFFIX: 100u"/2.54um SnPb ON PCB INTERFACE
 - WITH THIS SUFFIX: 78u"/2.00um Sn ON PCB INTERFACE
 - RETENTION TO PCB (NOTE 6)
 - TAIL OPTIONS (NOTE 5)
 - ALWAYS "00" (ZERO, ZERO)
 - NUMBER OF SIGNAL CONTACTS (NOTE 4)
 - ALWAYS "00" (ZERO, ZERO)
 - PLATING (NOTE 3)
 - BASE NUMBER
- ②. HOUSING MATERIAL: GLASS FILLED V-O HIGH TEMP THERMO PLASTIC.
SIGNAL CONTACT MATERIAL: COPPER ALLOY
- ③. PLATING OPTION:
I = SEE PRINT 10064183 FOR PLATING SPEC OF 51968-100CCC00EF AND 51968-100CCC00EFLF
- ④. SIGNAL CONTACTS, 004 TO 148 AVAILABLE FOR SOLDER TO BOARD.
020 TO 148 AVAILABLE FOR PRESS-FIT TO BOARD.
- ⑤. TAIL OPTIONS:
A = .135 ± .010 [3.43 ± .25] SOLDER TO BOARD
B = .090 + .005 / - .010 [2.29 + 0.13 / - 0.25] SOLDER TO BOARD
C = .154 ± .010 [3.91 ± 0.25] PRESS-FIT TO BOARD

DIM	LENGTH FORMULAS (SEE NOTE 8)
DIM "A"	.100 [2.54] x (CCC/4) + .650 [16.51] (NOTE 8)
DIM "B"	.100 [2.54] x (CCC/4) + .350 [8.89]
DIM "C"	.100 [2.54] x (CCC/4) + .300 [7.62]
DIM "D"	.100 [2.54] x (CCC/4) + .680 [17.27]

- ⑥. RETENTION TO PCB OPTIONS:
A = BOARD LOCK (REQUIRES .098 + .002 / -.001 [2.49 + 0.05 / - 0.03] THRU HOLE IN PCB)
MOUNTING FOOT HEIGHT: .220 [5.59]
NOT AVAILABLE FOR PRESS-FIT
B = .150 [3.81] THRU HOLE (REQUIRES .158 ± 0.003 [4.01 ± 0.08] THRU HOLE IN PCB).
MOUNTING FOOT HEIGHT .160 [4.06]
ALWAYS AVAILABLE FOR PRESS-FIT
- ⑦. MANUFACTURE'S NAME, P/N, AND DATE CODE TO APPEAR ON THIS SURFACE.
- ⑧. THE MAXIMUM OVERALL LENGTH (DIM A) OF A PART IS 8.00 [203.2]
9. PRODUCT SPECIFICATION GS-12-149
10. APPLICATION SPECIFICATION BUS-20-067.
11. FOR PRESS-FIT CONNECTORS USE FCI CAM TOOL 430140-XXX TO APPLY CONNECTOR TO PCB.

PCB NOTES:

12. ALL DIMENSIONS ARE BASIC UNLESS OTHERWISE SPECIFIED.
13. ALL THROUGH HOLES ARE LOCATED WITH A TRUE POSITION OF .004 [0.10]
14. ALL HOLE DIAMETERS ARE FINISHED HOLE SIZE.
- ⑮. $\varnothing 0.0453 \pm .001$ [1.151 ± 0.02] DRILLED HOLES PLATED WITH 0.0003 [0.007] MIN SnPb OR Sn OVER 0.001 [1.03] TO .003 [0.08] Cu PLATING TO ACHIEVE A .040 ± .003 [1.02 ± 0.08] HOLE.
16. A SYMBOL WILL BE NEXT TO ANY DIMENSION, VIEW, OR NOTE WHICH HAS BEEN MODIFIED WITH THE CURRENT DRAWING REVISION.

THIS FILE WAS ORIGINALLY CREATED IN THE PRO ENGINEER ENVIRONMENT AND ANY FUTURE REVISIONS TO THIS FILE MUST BE MADE IN THE PRO ENGINEER ENVIRONMENT

mat'l code				tolerances unless otherwise specified		CUSTOMER COPY		FCI www.fciconnect.com		
ltr	ecn no.	dr	date	linear	.XX±.01/.X±.3	projection 	title RIGHT ANGLE RECEPTACLE w/GUIDE PIN SIGNAL			
c					.XXX±.005/.XX±.13		INCH / MM 	product family PwrBlade		code 213
				angles	.XXX±.0020/.XXX±.051			size	dwg no 51968	
				dr	0° ± 2°	scale	1:2			
				enr	T. BRUNGARD 06/23/04					
				chr	M. GRAY 06/23/04					
				appd	M. GRAY 06/23/04					
sheet index	revision sheet									

form no. 7530-001-103

cage code 22526

Tous droits strictement réservés. Reproduction ou communication à des tiers interdite, sous quelque forme que ce soit sans autorisation écrite du propriétaire. Propriété de c.FCI. Droits de reproduction FCI.



All rights strictly reserved. Reproduction or issue to third parties in any form whatever is not permitted without written authority from the proprietor. Property of FCI. Copyright FCI.

PRODUCT NUMBER
51968-A00CCC00EF__
SEE NOTE 1

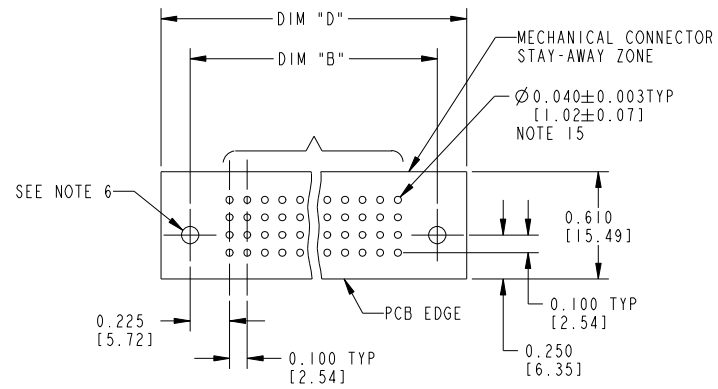
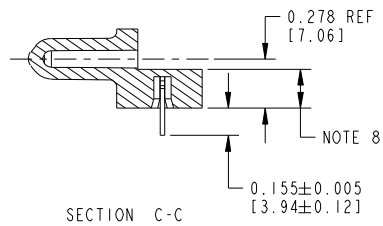
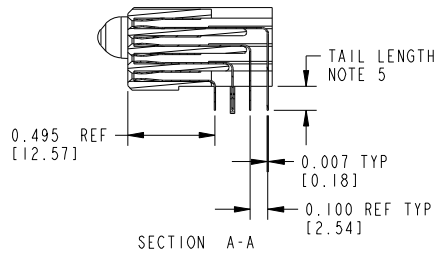

mat'l code				tolerances unless otherwise specified		CUSTOMER COPY		www.fciconnect.com	
ltr	ecn no.	dr	date	linear	.XX±.01/.X±.3		title		
c					.XXX±.005/.XX±.13		RIGHT ANGLE RECEPTACLE w/GUIDE PIN SIGNAL		
				angles	.XXX±.0020/.XXX±.051		product family		
				dr	0°±2°	INCH / MM		PwrBlade	
				enr	T. BRUNGARD 06/23/04	scale		code	
				chr	M. GRAY 06/23/04	1:1		213	
				appd	M. GRAY 06/23/04	A		SHEET 3 OF 3	
sheet index		revision sheet							

form no. 7530-001-103

cage code 22526