

Contact assignment:

- | | |
|-----------|---------------|
| 1) brown | 7) black |
| 2) blue | 8) grey |
| 3) white | 9) red |
| 4) green | 10) violet |
| 5) pink | 11) grey-pink |
| 6) yellow | 12) red-blue |

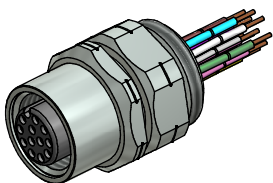

Technical specification :

Rated voltage: 30 V
IEC 61076-2-101

Current rating: 1,5A at 40°C
IEC 61076-2-101

Insulation resistance: >=100 MΩ
IEC 60512

Pollution degree: 3/2
IEC 60664-1

Degree of protection: IP 67, in mated condition
IEC 60529

Temperature range: -30°C ... +80°C

Mating cycles: >=100
IEC 60512-9a

Materials:

Contact: CuZn

Contact plating: Nickel, gold plated

Contact carrier: PBT GF, UL 94

Sealing: FPM

Counter nut: CuZn, nickel plated

Socket housing: CuZn, nickel plated

Grouting: Polyurethane-resin, UL 94

Installation specification:

recommended torque: 1-1,2 Nm

Conec installation tool: Torque wrench: 36-000200
Insert across flats 17: 36-000230

Part no:	Description:	Pos	Length L:	Wire:
43-01347	SAL - 12 - FKP12 - 0,5 - 9	12	0,5m	AWG 26 PVC, UL
43-xxxxx	SAL - 12 - FKP12 - ... - 9	12	x	

DO NOT ALTER CAD DRAWING BY HAND Directive 2002/95/EC RoHS compliant	Index: c 15.02.13 MG Ä4631 Data sheet revised, technical specification changed, materials corrected	dim. in mm		title: Female socket M12x1 with wire, frontmounting, reposition, PG9	
		date	name		
	tolerance of wire: L <= 4m: L + 40mm L > 4m: L + 1%	drawn	16.10.08	Fromm	dwg no: 43K1A779
	general tolerance: 0 ± 0,50mm 0,0 ± 0,25mm 0,00 ± 0,10mm	appd.	16.10.08	Mankopf	
CONEC ®				part no: see table	
THIS DRAWING MAY NOT BE COPIED OR REPRODUCED IN ANY WAY, AND MAY NOT BE PASSED ON TO A THIRD PARTY WITHOUT WRITTEN PERMISSION. OWNERSHIP AND COPYRIGHT OF CONEC GmbH					